

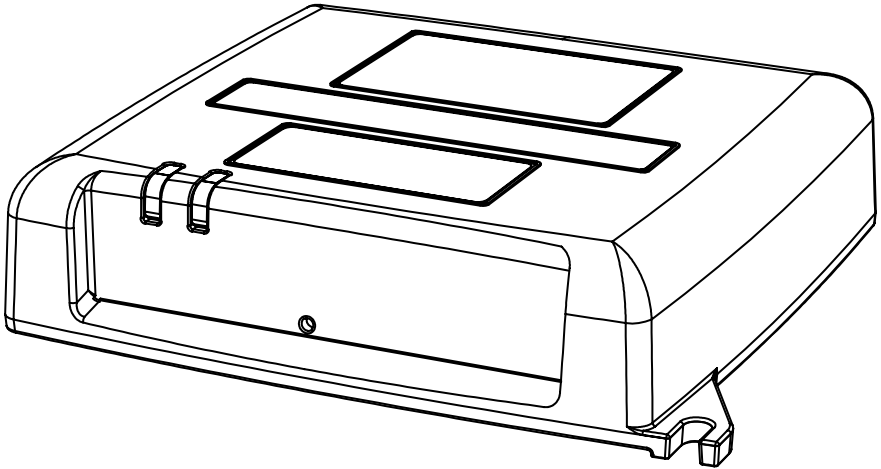

MM4GSFMAE011

FARMNAVIGATOR



4G AgriSIM INSTALLATION MANUAL



1. Technical specifications

- Dimensions: 105 mm x 102.3 mm
- Weight: 166 g
- Built-in GPS
- Triaxial accelerometer + gyro: ACC 500 Hz, min 0.125 g - max 16 g
- CANbus (J1939)
- 4G Modem
- Wi-Fi
- Waterproof: IP55
- Power supply: 9 - 24 Vdc
- Operating temperature: -20°C / + 65°C
- Storage temperature: -40°C / + 85°C
- Power consumption: 0.33A @12Vdc (4 W) typical; 0.7A @12Vdc (8.5 W) MAX
- Transmission frequency range: 791-2690 MHz

Technology	Maximum TX power
GSM 1800	29.02 dBm
E-UTRA BAND 3	23.02 dBm
UTRA BAND 1	23.01 dBm
WLAN	14.1 dBm
E-UTRA BAND 7	22.04 dBm
E-UTRA BAND 20	23.9 dBm
UTRA BAND 8	22.9 dBm
GSM 900	32.41 dBm

2. Connection scheme

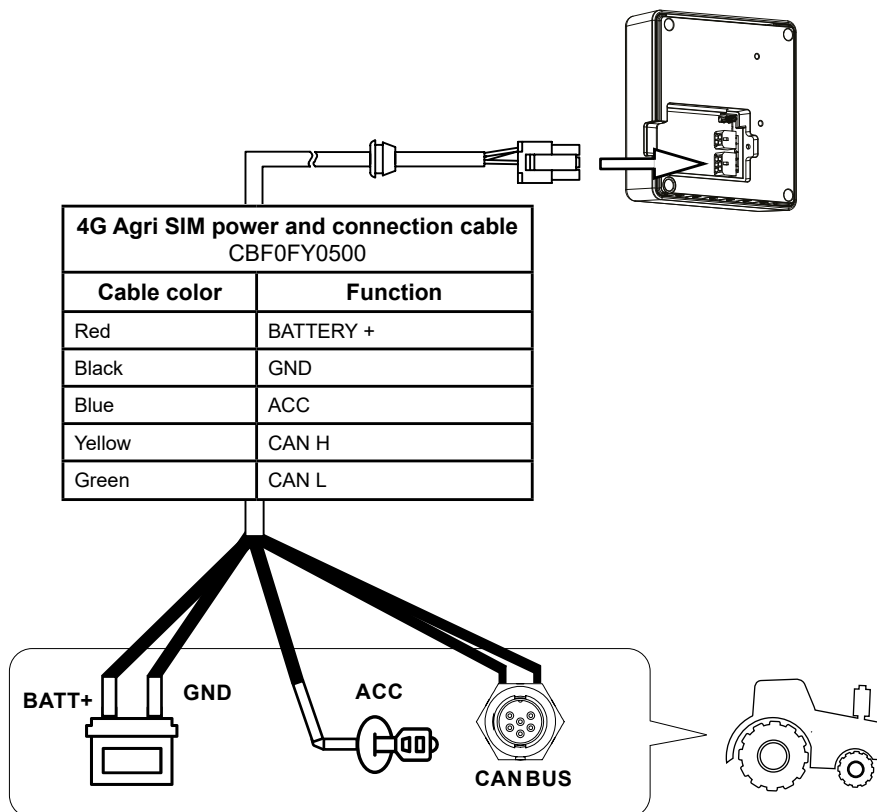

3. Installation

1

Install the 4G Agri SIM horizontally fixing both screws

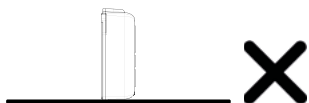
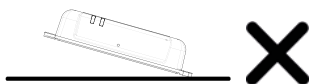
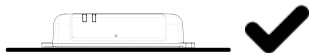
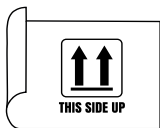
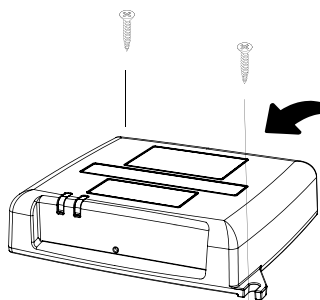

2

The cable of the 4G Agri SIM must be in the forward direction

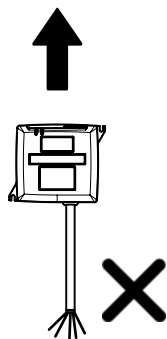
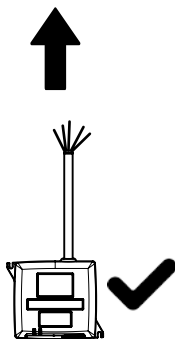
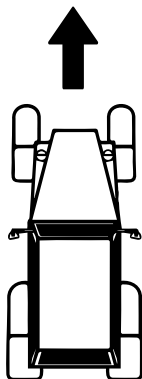

3

Do not cover the 4G Agri SIM with metallic parts

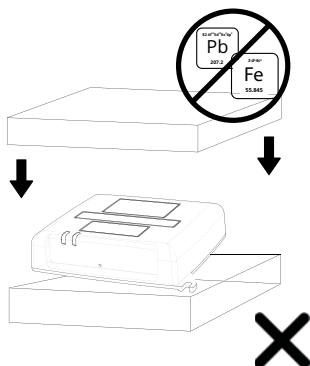
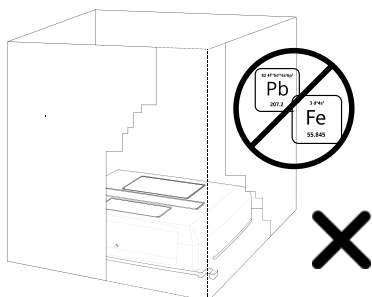

4. Getting started with 4G Agri SIM

4.1 Appearance

1. Cellular Network indicator
2. Wi-Fi indicator

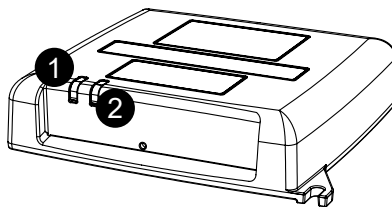

LED indicators

Led Indicator	Status	Description
Cellular Network	Red	No signal (or failed registration/connection to the network as in case of APN missing)
	Green	Successfully registered and connected to the network
	Green blinking	Transmitting data
	Blue	Successfully registered and connected to the network in roaming*
	Blue blinking	Transmitting data when roaming
Wi-Fi	Red	Wi-Fi initialization phase or in case of Wi-Fi failure
	Green	Ready for client access and connection
	Green blinking	Wi-Fi client(s) connected

NOTE: after switching off your engine, the 4G Agri SIM will remain active up to 30 seconds. This is a normal behavior.

How to activate 4G Agri SIM

A. Register 4G Agri SIM to get instant access to Internet services

In order to register your 4G Agri SIM, access www.myfarmnavigator.com website and complete the registration in few simple steps. Once it has been registered successfully, your 4G Agri SIM starts sharing information with the remote server.

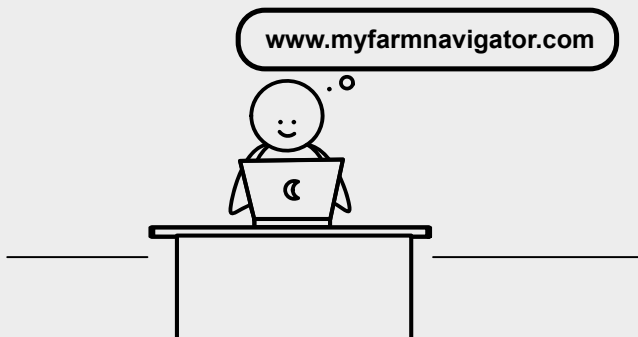

B. List of countries where the Internet services are supported

Andorra, Austria, Belgium, Bulgaria, Cyprus, Croatia, Denmark, Estonia, Finland, France, Greece, Germany, Hungary, Iceland, Ireland, Italy, Latvia, Liechtenstein, Lithuania, Luxembourg, Malta, Netherlands, Norway, Poland, Portugal, Czech Republic, Romania, UK, Spain, Slovakia, Slovenia, Sweden, Switzerland.

Contact support@avmap.it for info about Internet services in other countries.

4.3 Connecting your device(s)

4G Agri SIM provides connectivity to your FARMNAVIGATOR devices.

1. Open the G7 Farmnavigator Wi-Fi settings;
2. Select **AvMapHotspot-XXXXXX** among the available networks;
3. Insert the password.

NOTE: the default SSID and the default password key are printed on the labels which are both on the top side of the device and on the front page of this manual.

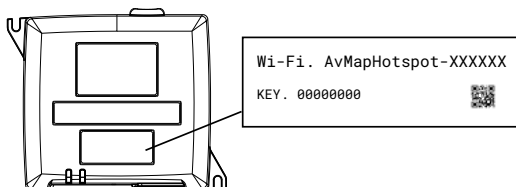

Connecting G7 Farmnavigator for the telematics services

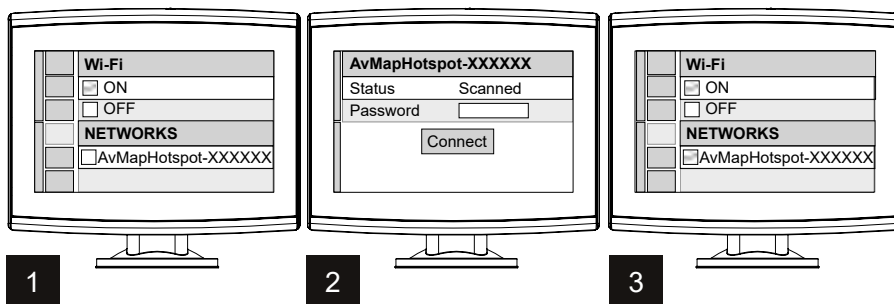

Connecting a smartphone or any other mobile device for the calibration procedure (par. 4.4)

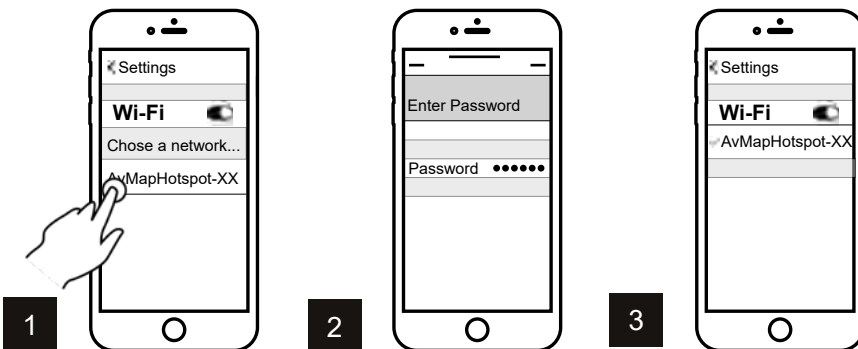

Note: 4G Agri SIM is designed to operate exclusively with AvMap Displays in order to provide access to the cloud services related to Smart agriculture features

4.4 Calibration

1. Drive the vehicle onto a flat area with no slope and set the park brake while the engine is ON;
2. Connect via Wi-Fi your PC or mobile device to the 4G Agri SIM (read par 4.3);

3. Access to the page hotspot.net/calib or, alternatively, **192.168.0.1/calib**
4. Press **Set Zero level**;
5. The calibration is now complete, quit the browser.

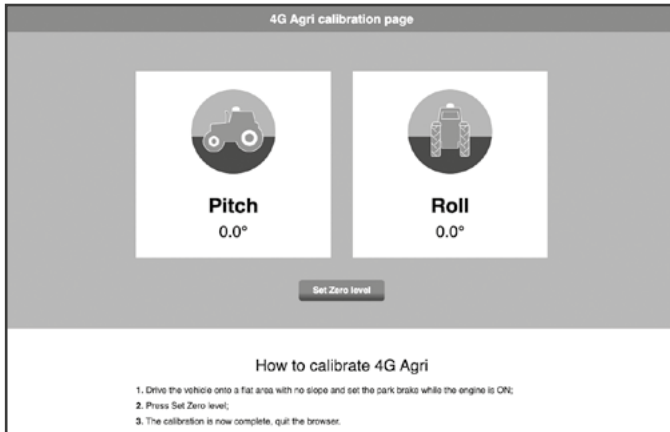

5. Main Settings Configuration

Settings can be changed online, using a Wi-Fi device (laptop or smartphone) connected to the Internet through the 4G Agri SIM.

1. To access the main settings page enter in the address bar of your Browser: **hotspot.net** or, alternatively, **192.168.0.1**
2. The main settings page is protected by a Login password that must be modified at first access. Default password is: **admin**.
It is possible to modify the Login password anytime using the **Modify Login Password** setting (read par 5.2).

The Main settings menu include Connected devices and Wi-Fi settings.

5.1 Connected devices

You can check the list of devices connected to your 4G Agri SIM by pressing the Connected Devices button in the main settings page. For each device, the name and the MAC address are shown.

5.2 Wi-Fi connection and settings

You can change the basic settings of your 4G Agri SIM Wi-Fi network through the Wi-Fi Settings menu as:

- **Network name (SSID):** Enter a string of maximum 32 characters. Upper case, lower case, numbers, standard and enhanced punctuation are allowed.
- **Security mode:** For OPEN mode, there is no need to set password. For WEP, WPA2 (AES)-PSK and WPA-PSK/WPA2-PSK mode, you need to set password for the security.
- **Password:** 8, 32 or 63 characters (upper case, lower case, and numbers) can be used for WPA2 (AES)-PSK and WPA-PSK/WPA2-PSK while 5 or 13 characters (upper case, lower case and numbers) can be used for WEP.

- **Station Number:** Set the numbers of devices connecting to your 4G Agri SIM.

6. Product conformity information

6.1 Simplified EU declaration of conformity

Hereby, AvMap Srlu, Viale Zaccagna 6, 54033 Carrara (MS), Italy declares that the equipment in the following table is in compliance with Directive 2014/53/EU

4G Agri SIM	UX04GA10AM
-------------	------------

The full text of the EU declaration of conformity is available at the following Internet address: eudeclaration.avmap.it

6.2 Simplified UK declaration of conformity

Hereby, AvMap Srlu, Viale Zaccagna 6, 54033 Carrara (MS), Italy declares that the radio equipment in the following table is in compliance with the relevant statutory requirements:

4G Agri SIM	UX04GA10AM
-------------	------------

The full text of the UK declaration of conformity is available at the following internet address: eudeclaration.avmap.it

7. Safety Information

AvMap disclaims any liability deriving from an improper use or installation of the product in a way that may violate the regulations and safety. It is highly recommended that the installation of the product will be performed by a qualified maintenance technician. Consult the Installation manual for a correct installation procedure.

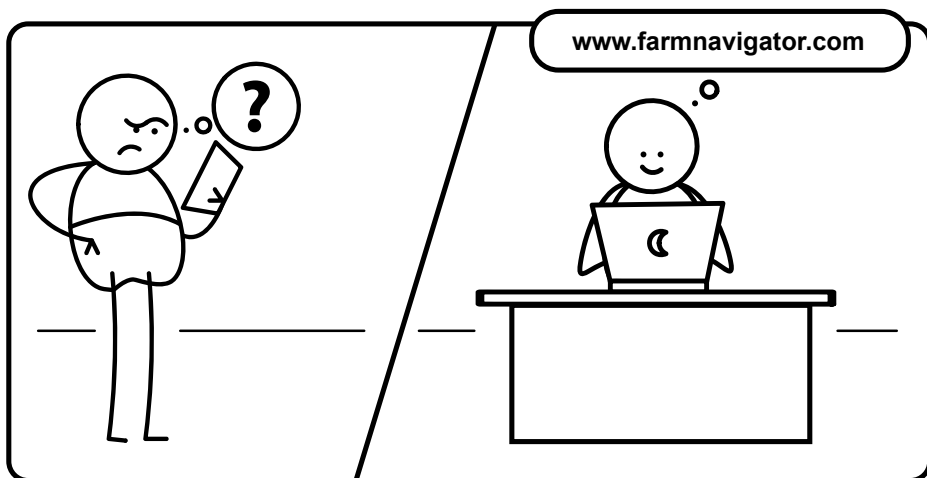

FARMNAVIGATOR

AvMap Srl
Viale Zaccagna, 6
54033 Carrara (MS), Italy
www.avmap.it
support@avmap.it

www.farmnavigator.com