

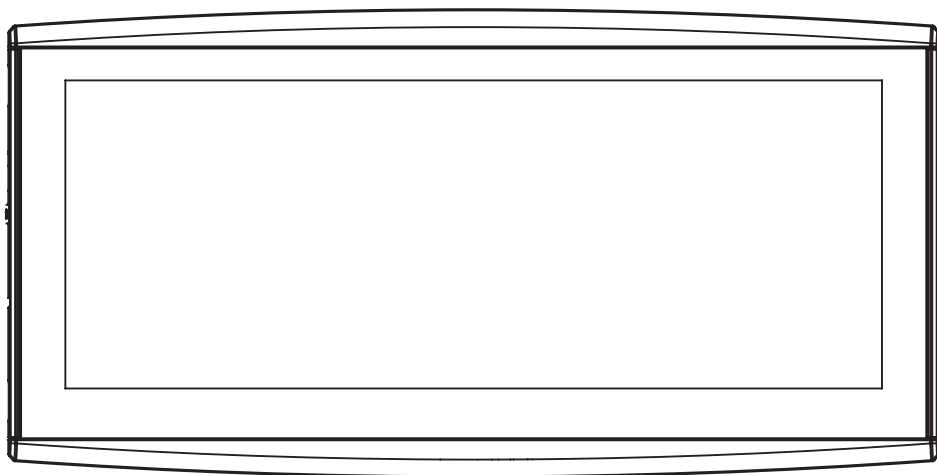

MMG12FMAE011

FARMNAVIGATOR



G12 *Panorama*

INSTALLATION MANUAL

1. Product description

The FARMNAVIGATOR G12 Panorama features a 12" display, parallel guidance software, manual and automatic boom sections control, wireless connection capability, Auto-Steering kit compatibility, and ISOBUS compatibility.

1.1 Content of the package

- G12 Panorama
- Power & I/O cable
- InCab cable
- USB-2xVideoIn-Ethernet cable
- RAM Double Socket Arm - C
- RAM Squared Ball Base - C
- Installation manual
- Warranty & Warning

2. Connections scheme

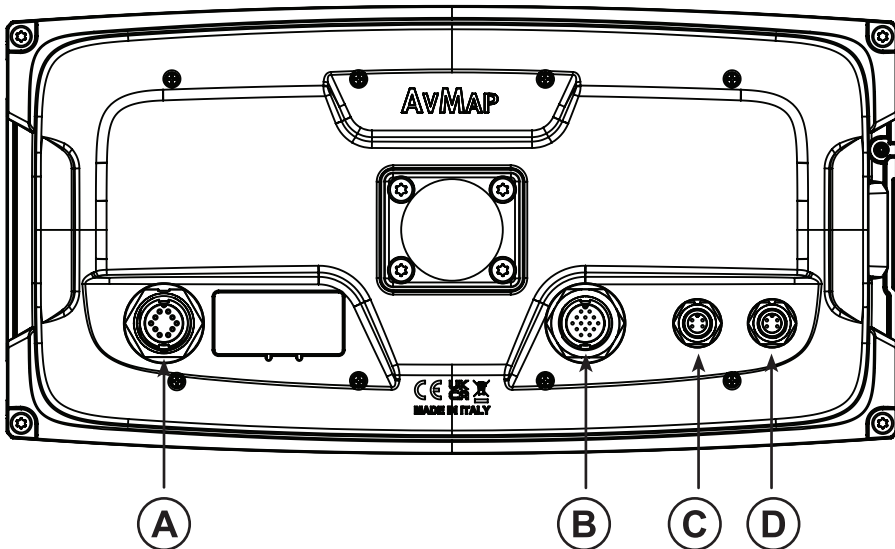

- Ⓐ – Connect to Power & I/O cable
- Ⓑ – Connect to USB-2xVideoIn-Ethernet cable
- Ⓒ – Not connected
- Ⓓ – Connect to InCab cable

2.1 Power & I/O cable (for GPS receiver and controllers)

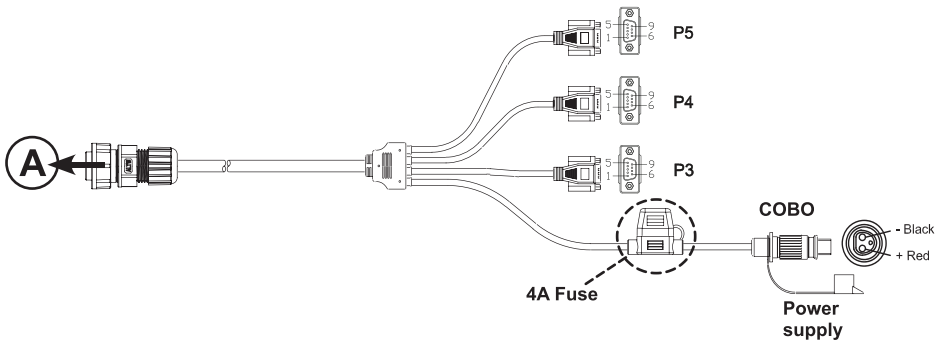

P5 PIN-OUT	
PIN n°	Function
2	GPS TX
3	GPS RX
4	GPS VCC
5	GPS GND

P4 PIN-OUT	
PIN n°	Function
2	DEVICE 2 TX
3	DEVICE 2 RX
5	DEVICE 2 GND

P3 PIN-OUT	
PIN n°	Function
2	DEVICE 1 TX
3	DEVICE 1 RX
4	DEVICE 1 VCC
5	DEVICE 1 GND

2.2 USB-2xVideoIn-Ethernet cable (for camera, Auto-Steering and other devices)

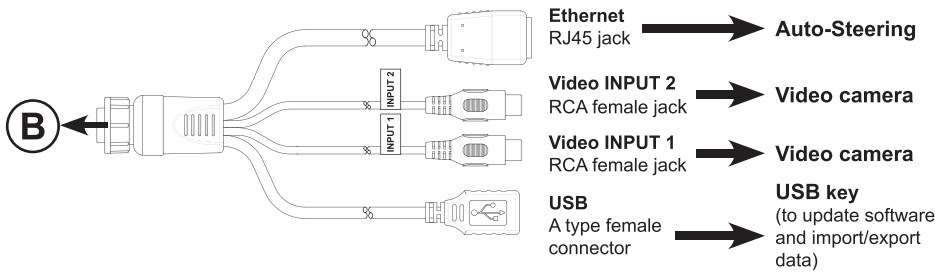

2.3 InCab cable (for ISOBUS connection)

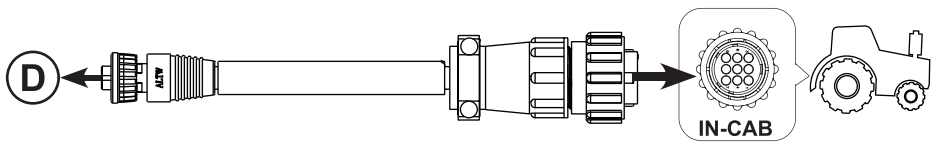

ATTENTION: The In-cab cable is not waterproof. Do not use outside the tractor cab.

3. Ram mount installation

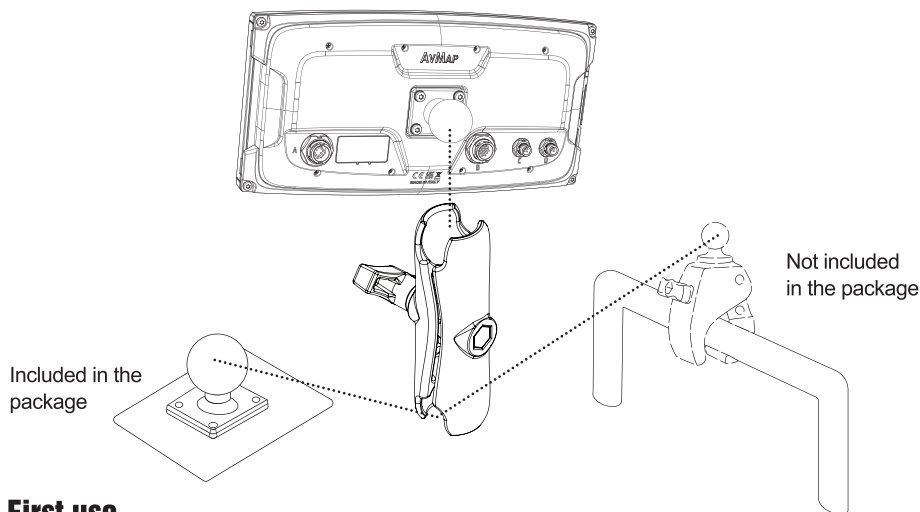

4. First use

4.1 Power ON/OFF

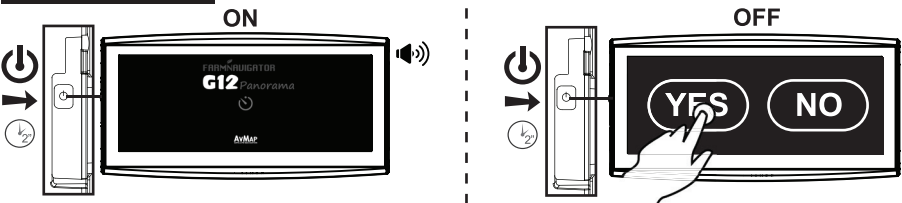

4.2 Change brightness

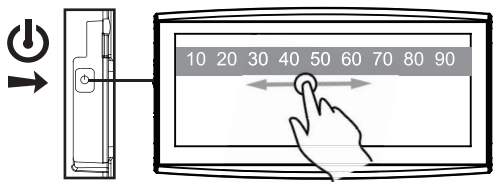

4.3 MicroSD Instructions

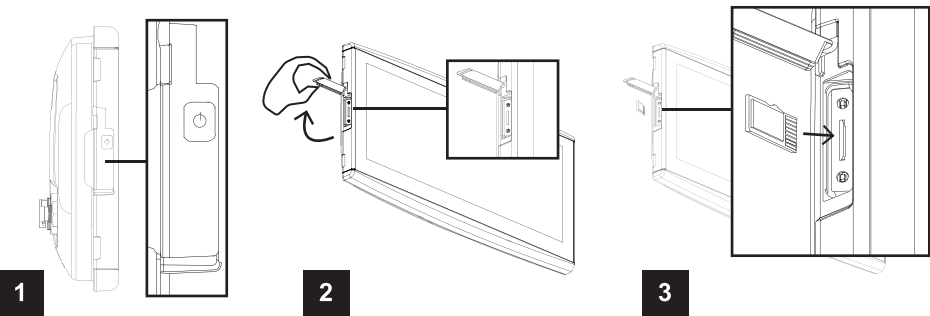

5. Operations

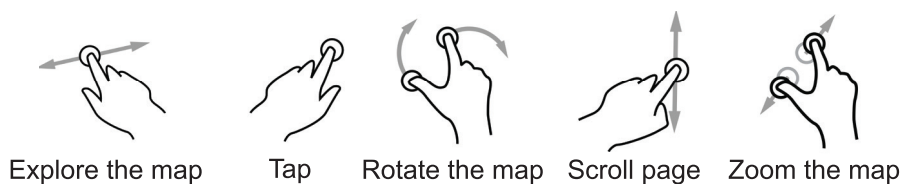
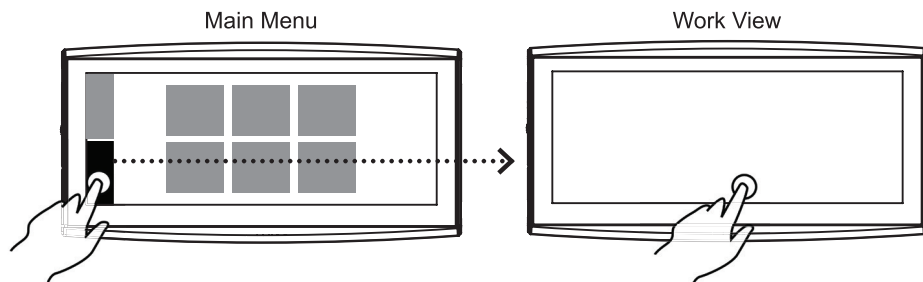

5.2 Menu on Work View

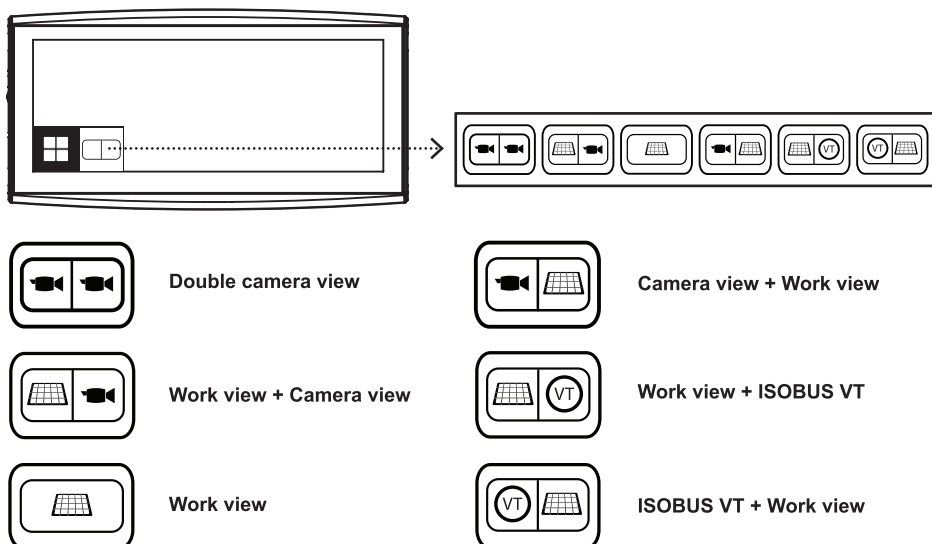

5.3 Portrait / Landscape settings

Default setting is “Auto”: rotate the unit to change from landscape to portrait orientation automatically.
To change orientation:

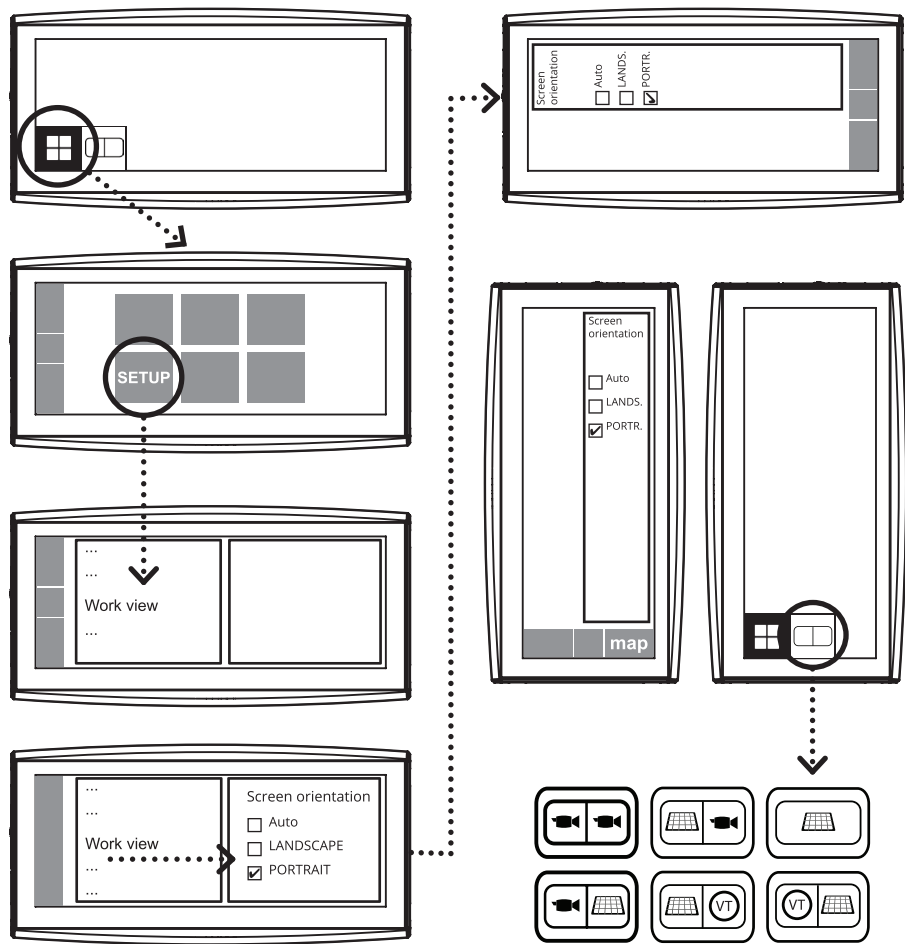

5.4 Start a Job



5.5 Buttons on map

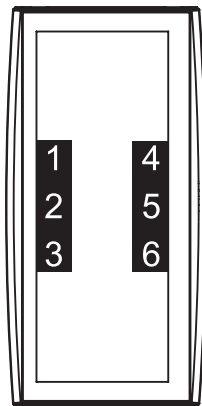
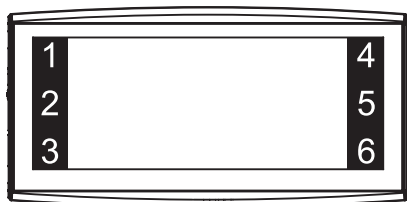

- | | | |
|---|--|------------------------------|
| 1 | | Create and manage guidelines |
| 2 | | Create a field |
| 3 | | Set the headland area |
| 4 | | Start/Stop Auto-Steering |
| 5 | | Nudge control |
| 6 | | Start/Stop the job |

6. Product conformity information

6.1 Simplified EU declaration of conformity

Hereby, AvMap Srl, Viale Zaccagna 6, 54033 Carrara (MS), Italy declares that the radio equipments in the following table are in compliance with Directive 2014/53/EU.

G12 Panorama	P3MU100WAM
G12 Panorama VT	P3MU10VWAM
G12 Panorama FULL	P3MU10FWAM

The full text of the EU declaration of conformity is available at the following internet address:
eudeclaration.avmap.it

6.2 Simplified UK declaration of conformity

Hereby, AvMap Srlu, Viale Zaccagna 6, 54033 Carrara (MS), Italy declares that the radio equipment in the following table is in compliance with the relevant statutory requirements:

G12 Panorama	P3MU100WAM
G12 Panorama VT	P3MU10VWAM
G12 Panorama FULL	P3MU10FWAM

The full text of the UK declaration of conformity is available at the following internet address:
eudeclaration.avmap.it

7. Safety Information

AvMap disclaims any liability deriving from an improper use or installation of the product in a way that may violate the regulations and safety. It is highly recommended that the installation of the product will be performed by a qualified maintenance technician. Consult the Installation manual for a correct installation procedure.

8. Technical specifications

- Dimensions: 334 x 168 x 92 mm
- Weight: 1900 g
- Display: 12.3" bonded LCD
- Display resolution: 1920x720 px
- Display brightness: 1000 nits
- Capacitive multi-touch screen
- Inputs / outputs:
 - 3x Serial ports
 - 2x Video inputs
 - 1x USB
 - 1x Ethernet
 - 2x CAN Bus
- Wireless LAN connection capability
- Water and dustproof IP56
- Supply voltage: 10-35 Vdc
- Operating temperature: -10°C / +60°C
- Storage temperature: -30°C / +80°C
- Transmitting frequency range: 2400 – 2483 MHz
- Maximum transmitting power: 100 mW
- Power consumption: 1.6A MAX @12V (~18W)



AvMap Srl
Viale Zaccagna, 6
54033 Carrara (MS), Italy
www.avmap.it
support@avmap.it

www.farmnavigator.com